

SITE DATA

APPLICATION # DOA-2011-01165
 CONTROL# 84-152
 PROJECT# 00205-000
 NAME OF DEVELOPMENT BOCA DEL MAR PUD
 TIER US
 EXISTING USE RESIDENTIAL/VACANT
 PROPOSED USE RESIDENTIAL SF / TH / ZLL
 FUTURE LAND USE HR-8
 ZONING DISTRICT AR-PUD
 SECTION/TOWNSHIP/RANGE 21/47/42, 22/47/42, 26/47/42, 27/47/42, 28/47/42, 34/47/42
 35/47/42
 PCN OF AFFECTED AREA 00-42-47-26-05-641-0000
 00-42-47-27-56-000-0691

CONCURRENCY APPROVAL
 TOWNHOME - 138 UNITS
 ZLL RESIDENTIAL - 150 UNITS

CONCURRENCY IS APPROVED FOR THE ABOVE USES AND AMOUNTS SHOWN ON THIS PLAN.

TRAFFIC ANALYSIS ZONE 684 & 685
 BCC APPROVAL 11/17/05
 RESOLUTION: R-2005-2293

GROSS ACREAGE 129.894 AC.
 NET ACREAGE 122.697 AC.
 (less 7.197 AC. for L.W.D.D. Lateral No.50 per ORB 2336/998)

RECREATION AREA REQUIRED (.006 AC. / UNIT) 1.74 AC.
 RECREATION AREA PROVIDED* 3.01 AC.
 *CALCULATION DOES NOT INCLUDE THE OPEN SPACE WITHIN AMENITY AREAS (NEIGHBORHOOD PARKS)

MAX. BUILDING HEIGHT 35'
 MAX. # OF STORIES 2 STORIES
 OPEN SPACE PROVIDED WITHIN AFFECTED AREA 71.5%
 WORKFORCE HOUSING UNITS REQUIRED (2.5% of 291): 7 UNITS
 (utilizing the limited Incentive Option)

SITE AREA TABULAR

POD:	TYPE	UNITS	ACREAGE	POD DENSITY
POD 64A	ZLL	27	14.18 AC.	1.9
POD 64B	ZLL/TH	46/40	24.48 AC.	3.5
POD 64C	---	---	21.56 AC.	---
POD 64D	---	---	6.57 AC.	---
POD 64E	TH	54	16.92 AC.	3.19
POD 64F	ZLL/TH	48/44	26.84 AC.	3.42
POD 64G	ZLL	29	16.33 AC.	1.77
POD 69A	---	---	3.01 AC.	---
SUBTOTAL		288	129.89 AC.	2.21

POD 64C LESS OUT (L.W.D.D. Lateral No. 50 - (ORB 10900/221 & 24120/1653)) 2.868 AC.

POD 64C LESS OUT (L.W.D.D. Lateral No. 50 - (ORB 10900/221 & 24120/1653)) 4.329 AC.

TOTAL POD AREA 288 units 122.69 AC. (150 ZLL, 138 TH)



MIZNER TRAIL PROPERTIES AT BOCA DEL MAR PUD PRELIMINARY SITE PLAN
 PREPARED FOR MIZNER TRAIL GOLF CLUB, LTD.
 PALM BEACH COUNTY, FLORIDA

REVISION DATES

DATE	APPROVAL	NOTES

AMENDMENTS

ZONING STAMP

"ALL DRAWINGS, SPECIFICATIONS AND RELATED DOCUMENTS ARE THE COPYRIGHT PROPERTY OF THE LANDSCAPE ARCHITECT AND MUST BE RETURNED UPON REQUEST. REPRODUCTION OF DRAWINGS, SPECIFICATIONS AND RELATED DOCUMENTS IN PART OR IN WHOLE IS FORBIDDEN WITHOUT THE LANDSCAPE ARCHITECTS WRITTEN PERMISSION."

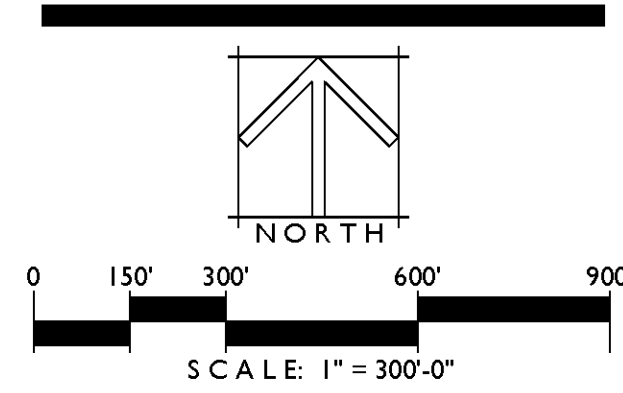

DRAWN BY: DHM/CES
 DRAWING #: 2013-4-16_Mizner Trail CSP_685.2_recovery.dwg
 FILE #: 685.2

SHEET # PSP.0

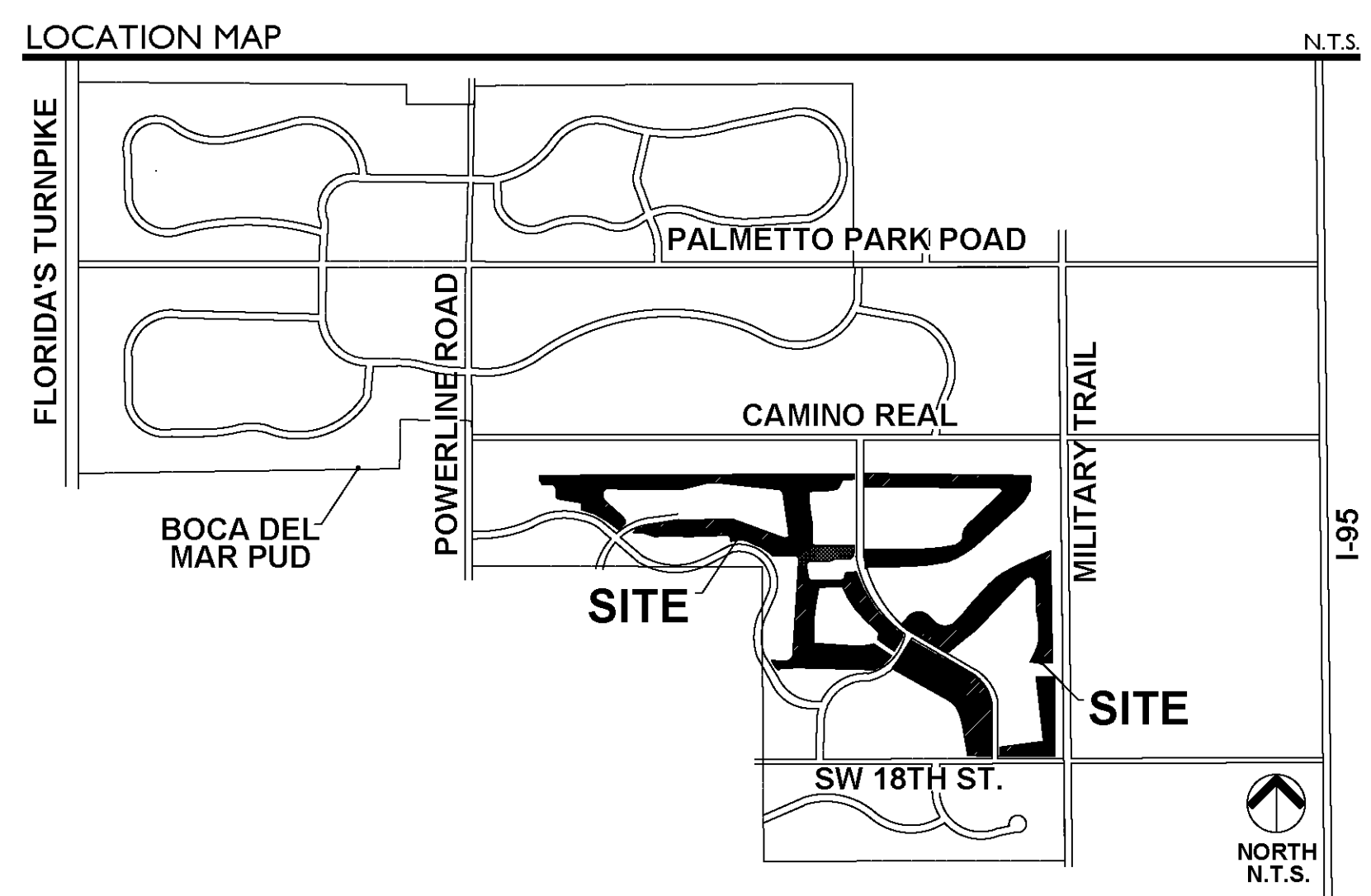
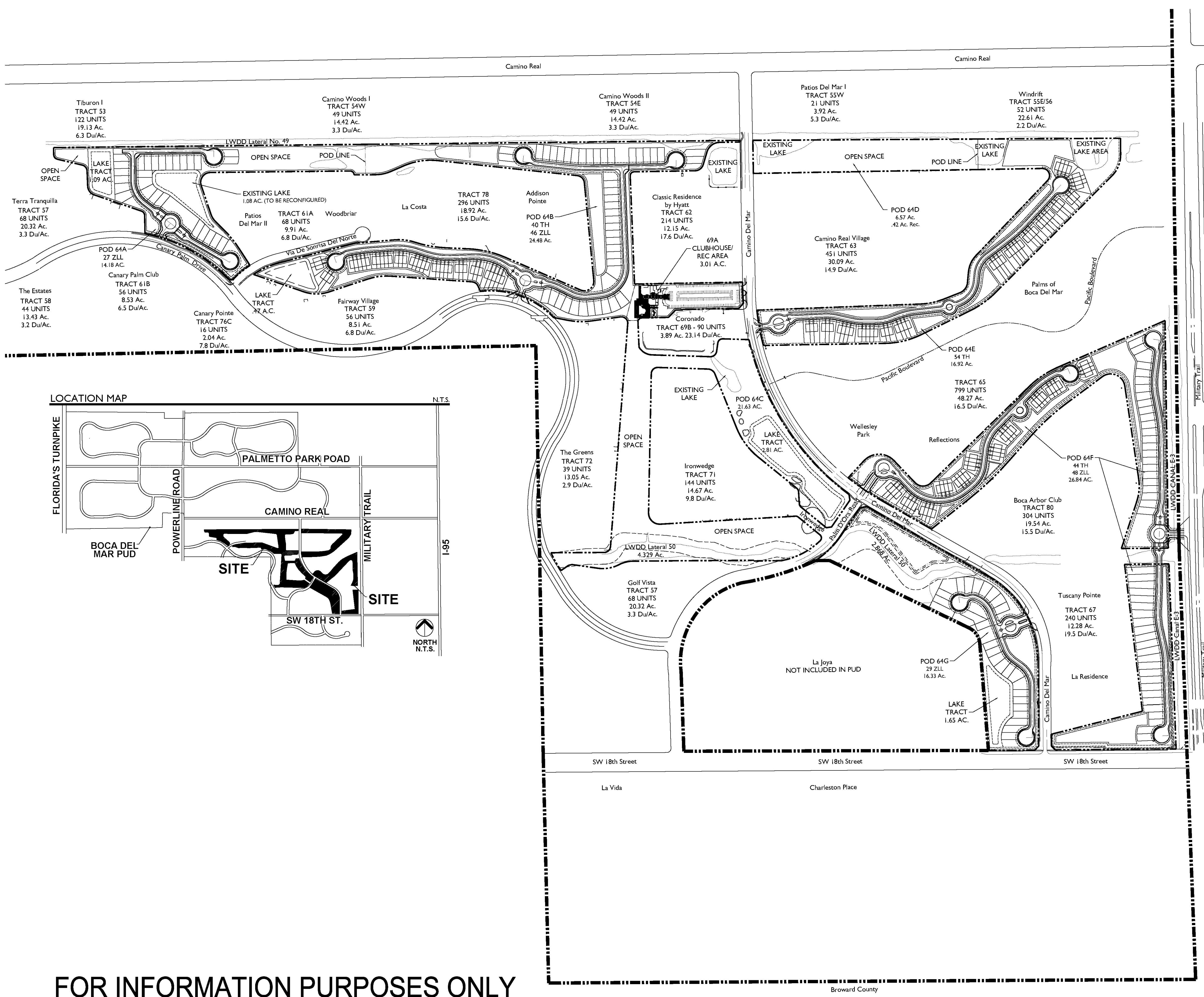

FOR INFORMATION PURPOSES ONLY